

PRODUCT INFORMATION PACKET

marathon[®]
Motors

Model No: 200LTFC6589
Catalog No: R344A
30,1200,TEFC,200L,3/60/230/460
TEFC



Regal and Marathon are trademarks of Regal Beloit Corporation or one of its affiliated companies.
©2018 Regal Beloit Corporation, All Rights Reserved. MC017097E

REGAL[®]



Nameplate Specifications

Output HP	30 Hp	Output KW	22.4 kW
Frequency	60 Hz	Voltage	230/460 V
Current	77.0/38.5 A	Speed	1190 rpm
Service Factor	1.15	Phase	3
Efficiency	93.6 %	Duty	Continuous
Insulation Class	F	Design Code	B
KVA Code	F	Frame	200L
Enclosure	Totally Enclosed Fan Cooled	Overload Protector	No
Ambient Temperature	40 °C	Drive End Bearing Size	6312
Opp Drive End Bearing Size	6212	UL	Recognized
CSA	Y	CE	Y
IP Code	55		

Technical Specifications

Electrical Type	Squirrel Cage Inverter Rated	Starting Method	Part Wdg Start & Wye Start Delta Run Or Inverter
Poles	6	Rotation	Reversible
Mounting	Rigid base	Motor Orientation	Horizontal
Drive End Bearing	Ball	Opp Drive End Bearing	Ball
Frame Material	Cast Iron	Shaft Type	IEC
Overall Length	29.52 in	Shaft Diameter	2.166 in
Shaft Extension	4.31 in	Assembly/Box Mounting	F3
Outline Drawing	B-SS622240	Connection Diagram	004172.01ME

This is an uncontrolled document once printed or downloaded and is subject to change without notice. Date Created: 06/29/2018

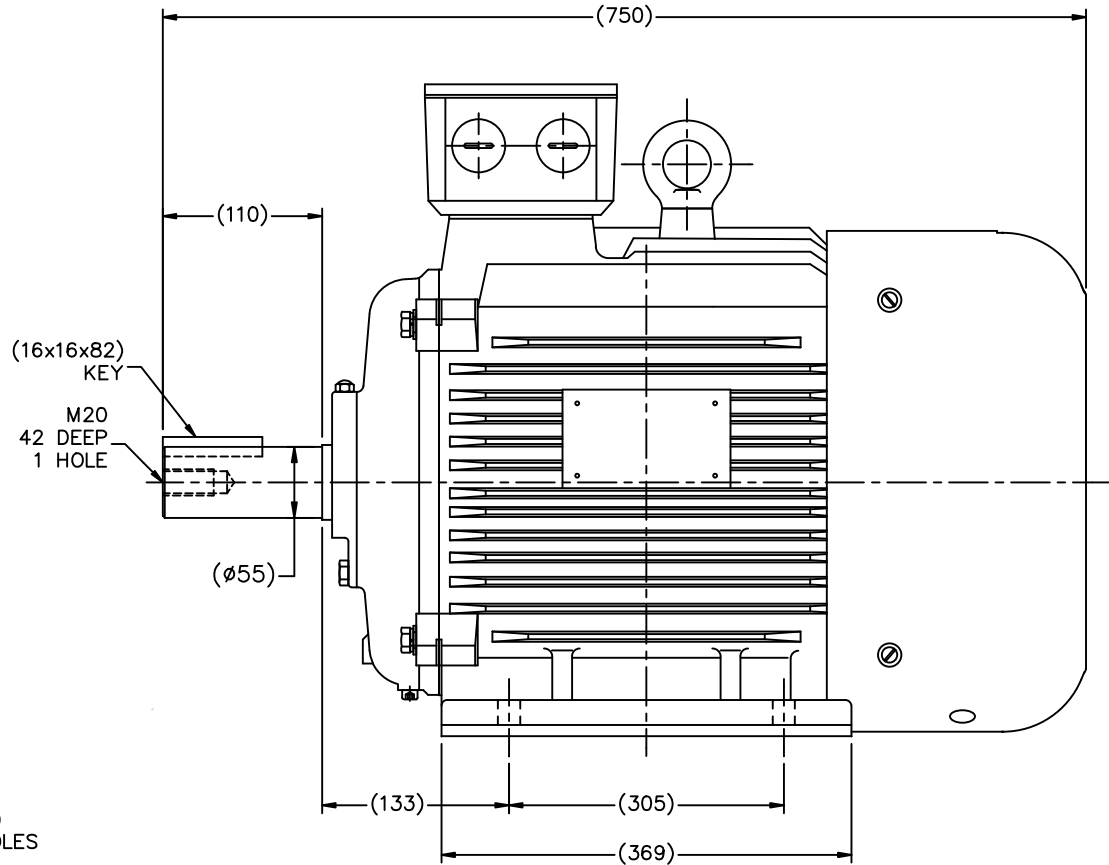
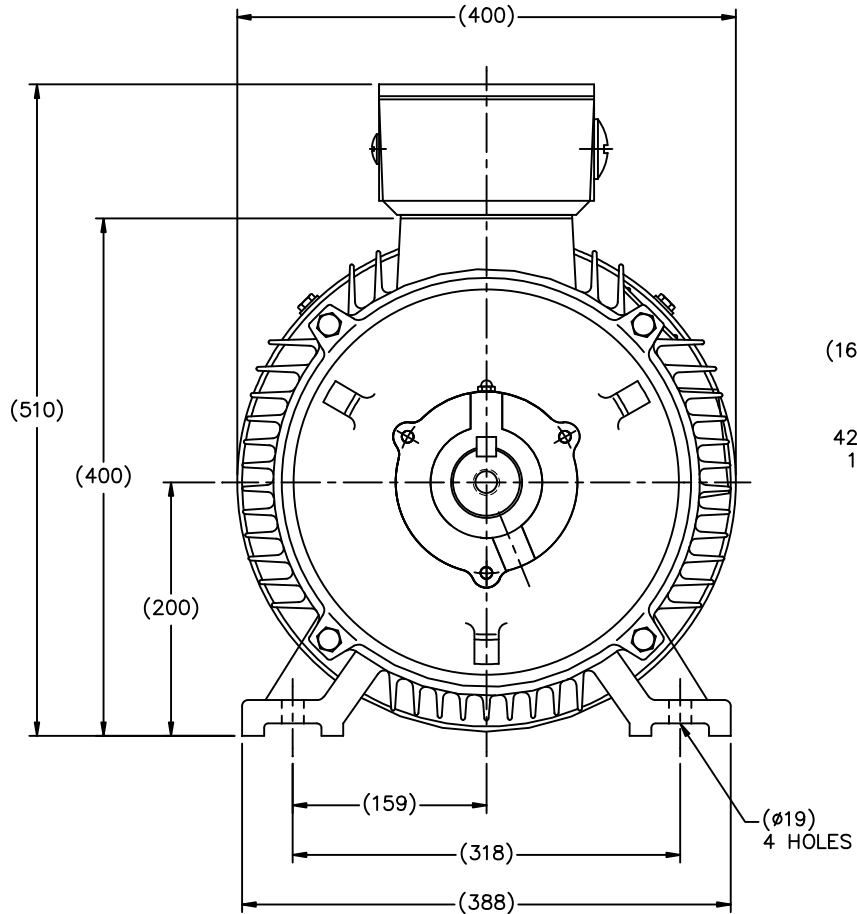

(MAY NOT BE DRAWN TO SCALE)

(DIMENSIONS ARE IN MILLIMETERS)

DF200L	193327.60
	193330.60
	193328.60
	193323.60
	193326.60
FRAME	PART #

		TOLERANCES UNLESS SPECIFIED			DRAWN MSG 11-17-2010				
		DEC.	METRIC		CHK MJS 11-18-2010				
		.X	±2.5	APPD SB 11-18-2010	SCALE 1=4				
		.XX	±.76	TITLE OUTLINE - IEC PREMIUM					
		.XXX	±.127	DF200L-2, 4, 6					
		.XXXX	±.0127	MAT'L	REF				
NO.	REVISION	BY & DATE	CHK	ANG	FINISH	PREV			
THIS DRAWING IN DESIGN AND DETAIL IS OUR PROPERTY AND MUST NOT BE USED EXCEPT IN CONNECTION WITH OUR WORK ALL RIGHTS OF DESIGN AND INVENTION ARE RESERVED THIS IS AN ELECTRONICALLY GENERATED DOCUMENT - DO NOT SCALE THIS PRINT			RFP	11-18-2010	CAD FILE SS622240	SIZE B	DRAWING NO. SS622240	PAGE OF	REV.
			DIST						

WYE - DELTA STARTING USEABLE ON 2,4 AND 6 POLE MOTORS.

LOW VOLTAGE CONNECTION

HIGH VOLTAGE CONNECTION

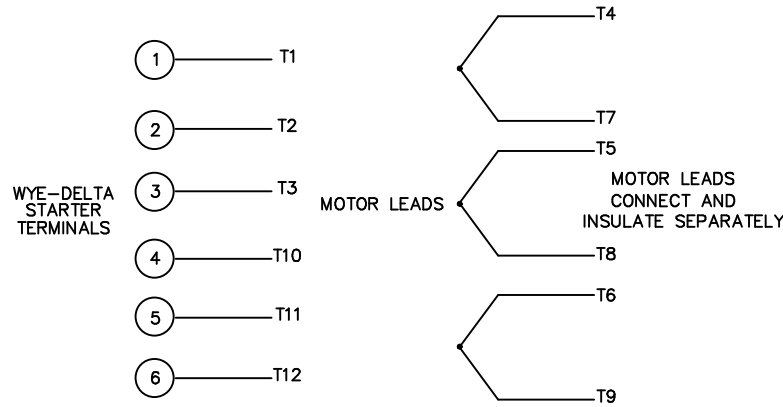
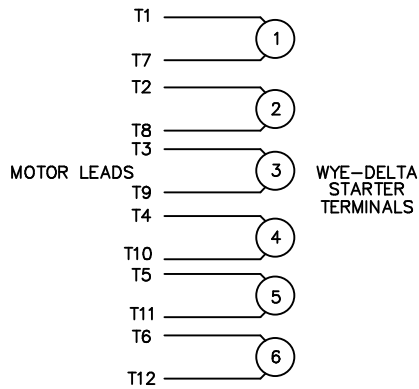

REFER TO THE WYE-DELTA STARTER CONNECTION INSTRUCTIONS FOR PROPER CONNECTION OF POWER LINES TO STARTER.

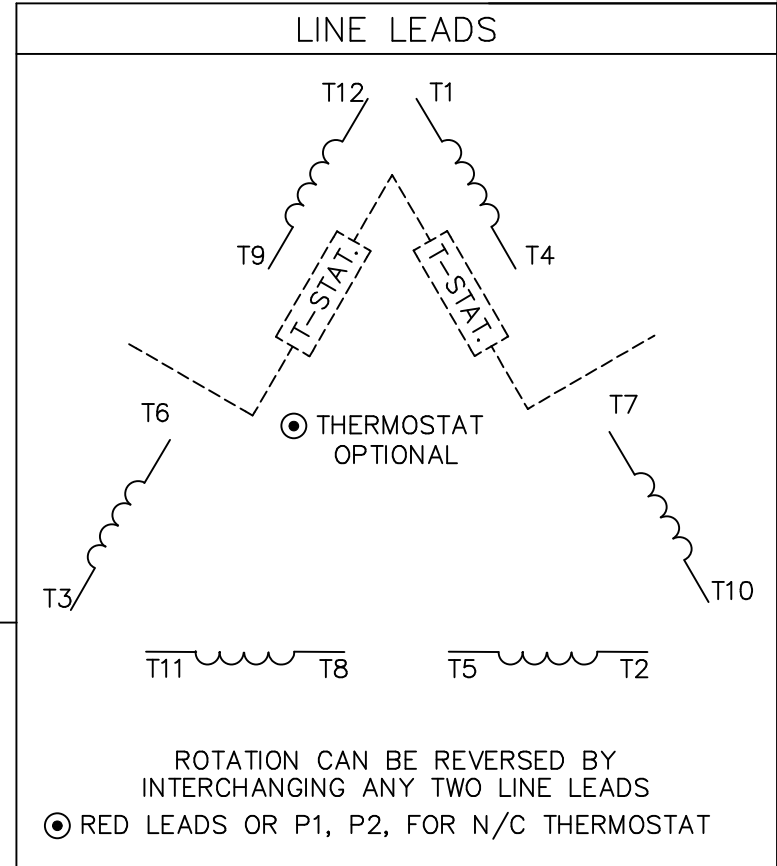

PART WINDING START USABLE ON 4 & 6 POLE MOTORS LOW VOLTAGE CONNECTION ONLY

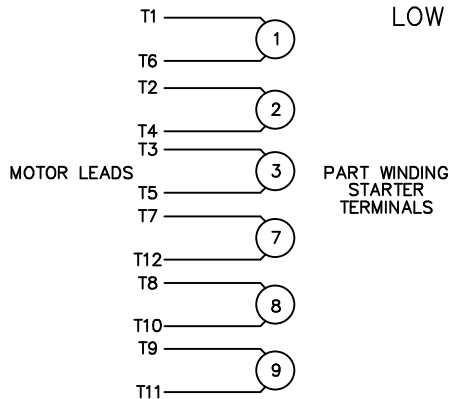

REFER TO THE PART WINDING STARTER INSTRUCTIONS FOR PROPER CONNECTION OF POWER LINES TO STARTER.

REFER TO THE CUTLER - HAMMER OR EQUIV. FOR PROPER SELECTION OF OVERLOAD HEATER COILS.

ACROSS THE LINE START & RUN				
	LINE 1	LINE 2	LINE 3	JOIN & INSULATE SEPARATELY
HIGH VOLT	T1, T12	T2, T10	T3, T11	(T4, T7) (T5, T8) (T6, T9)
LOW VOLT	T1, T6 T7, T12	T2, T4 T8, T10	T3, T5 T9, T11	

NO.	REVISION	BY & DATE	CHK	TOLERANCES UNLESS SPECIFIED	
				DEC.	INCHES
				.X	±.1
03	REV'D LOW VOLTAGE CONN. LEADS PER ELEC.	BJB 06/07/00		.XX	±.01
02	ADDED T-STAT. NOTES PER ELECTRICAL	KMM 06/02/98		.XXX	±.005
01	REDRAWN TO CAD	DBT 06/02/97		.XXXX	±.0005
				ANG	±1/2°

MARATHON ELECTRIC

TITLE DELTA - WYE CONNECTION DIAGRAM

MAT'L.

FINISH

DRAWN WLW 09/08/77

CHK RPB 09/12/77

APPD JCW 09/12/77

SCALE 1=1

REF

FMF

PREV

RFP	CAD FILE 00417201ME	SIZE A	DRAWING NO. 004172-01ME	REV. 03
DIST				

** Subject to change without notice.

Date: 6/19/2017

200L TFC6899

Customer:



Submital

Attention:

FAREEDA DUDEKULA

Data @ 460 V

Submitted by:

Motor Load Data

Load	0%	25%	50%	75%	100%	115%	125%	LR
Current (Amps)	15.5	18.0	23.0	30.5	38.6	43.4	47.5	201
Torque (ft-lb)	0.00	33.0	67.0	100	133	153	166	213
RPM	1200	1197	1195	1192	1190	1188	1185	0
Efficiency (%)		90.2	93.6	94.1	93.6	93.6	93.6	
P.F. (%)	4.5	45.0	66.0	74.5	78.0	78.0	78.5	0.0

Motor Speed Data

	LR	Pull-Up	BD	Rated	Idle
Speed (rpm)	0	300	1140	1190	1200
Current (Amps)	201	190	130	38.6	15.5
Torque (ft-lb)	213	180	290	133	0.00

Information Block

HP	30.0
Sync. RPM	1200
Frame	326
Enclosure	TFC
Construction	TFC
Voltage	30/460/200/40 V
Frequency	60 Hz
Design	B
LR Code letter	F
Service Factor	1.15
Temp Rise @ FL	57 °C
Duty	CONT
Ambient	40 °C
Elevation	1,000 feet
Rotor/Shaft wkt	0.00 Lb-Fe
Ref Wdg	T16106012 FR
Sound Pressure @ 1M	72 dBA
VFD Rating	CONSTANT 2:1
Outline Dwg	B-SS622240
Conn. Diag	004172.01ME
Additional Specifications:	
0	

EQUIV CKT (OHMS / PHASE)				
R1	R2	X1	X2	Xm
0.00000	0.00000	0.00000	0.00000	0.00000

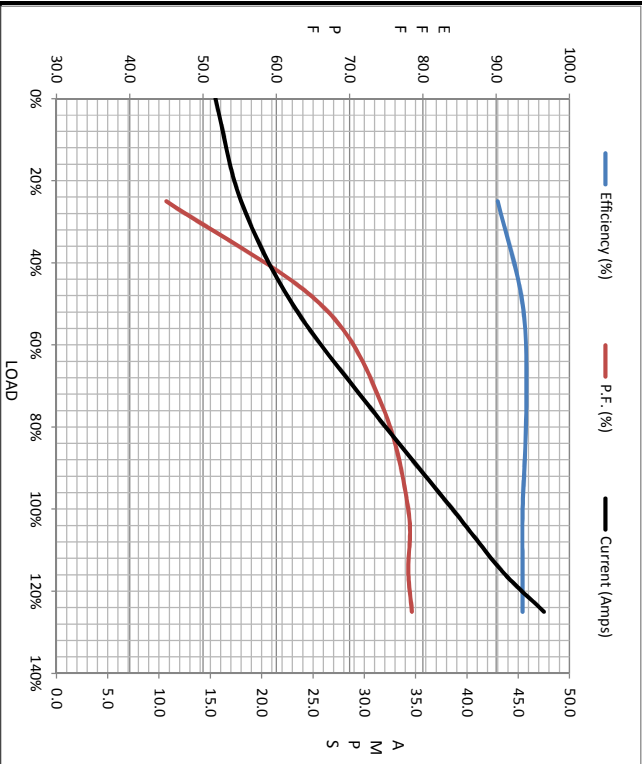

Speed - Torque Curve

